

No. 95

26th November 1997

Nauru

G.N. No. 456 /1997

ENGAGEMENT TO MARRY

NAME OF PARTIES: **CARISON BRUNO HARTMAN** of Anabar District and
GABRISSA SHIRANI GIOURA of Nibok District.

DATE OF ENGAGEMENT: 17th November, 1997

VASSAL A. GADOENGIN
MINISTER IN CHARGE

NAME OF PARTIES: **TIVANGA TEERUA** from Kiribati and
DERESA TOM of Nibok District.

DATE OF ENGAGEMENT: 26th November, 1997

VINSON DETENAMO
MINISTER IN CHARGE

G.N.No. 457 /1997

BIRTHS, DEATHS AND MARRIAGES
ORDINANCE 1957 - 1967

Births, Deaths and Marriages registered the week ended 21st November, 1997, were:-

BIRTHS

1. NAURUAN:

| <u>NAME</u> | <u>DATE OF BIRTH</u> | <u>SEX</u> | <u>TRIBE</u> | <u>REG'D DISTRICT</u> | <u>MOTHER'S NAME</u> |
|---|-----------------------------|-------------------|---------------------|------------------------------|-----------------------------|
| Jim-Dunn Deradab | 04/11/96 | M | Eamwit | Baitsi | Indira Dekarube |
| Javin | 05/06/97 | M | Iruwa | Boe | Fianga Kamtaura |
| Vicka Victoria Brigette Aisha Lucia Lilisani | 12/06/97 | F | Eamwitmwit | Yaren | Sophia Dageago |
| Maggie-Mae Margie Michola Mabel Eiraginugo Elika Dykina Deimica Antasha Anastacia Zenaris Zanjriella Olannyko Ojean Aecana Bonnie - Tyler Baby Janessa Thalia - Acacia Mercy X-Tina | | | | | |
| Sarki Roseann Selina | 17/09/97 | F | Eamwitmwit | Boe | Mabel Depoudu |
| Michelle Stephanie Sweet - Rose Eab | 14/08/97 | F | Iruwa | Meneng | Rasella Bagaga |
| Anthony Cooper Dominum Hilson Hans | 25/08/97 | M | Eamwit | Nibok | Hilda Demingauwe |
| Joette Xena Pridika Rae Mysumo Tasha Noni | 21/10/97 | F | Emea | Anetan | Raelene Ika |
| Bianca Shoshana Diana Kimberly Ronna | 10/11/97 | F | Eoaru | Anabar | Rosella Dageago |

No. 95 26th November 1997 Nauru

G.N. No. 457 /1997 (cont'd)

2. O.P.I.:

| <u>NAME</u> | <u>DATE OF BIRTH</u> | <u>SEX</u> | <u>RESIDENCE</u> |
|-------------------|----------------------|------------|------------------|
| Buriti MARCONI | 08/10/97 | F | NPC Location |
| Tumera TEBURABURA | 28/10/97 | M | NPC Location |
| Merilyn TOKANNATA | 06/11/97 | F | NPC Location |

3. CHINESE: - NIL -

DEATHS

1. NAURUAN

| <u>NAME</u> | <u>DATE OF DEATH</u> | <u>SEX</u> | <u>AGE</u> | <u>REG'D DISTRICT</u> | <u>TRIBE</u> |
|---------------------|----------------------|------------|------------|-----------------------|--------------|
| Einana GADEOWA | 12/11/97 | F | 83yrs | Baitsi | Eamwitmwit |
| Paul TATUM | 13/11/97 | M | 44yrs | Uaboe | Deiboe |
| Josephine TAUNTEANG | 15/11/97 | F | 37yrs | Meneng | Eamwitmwit |

2. O.P.I.:

| <u>NAME</u> | <u>DATE OF DEATH</u> | <u>SEX</u> | <u>NPC LOCATION</u> |
|--------------|----------------------|------------|---------------------|
| Toora TEBOTU | 23/11/97 | M | NPC Location |

3. CHINESE: - NIL -

MARRIAGES

FRANKIE AMRAM of Boe District and CHRISTINA ISABELLA GIOUBA of Yaren District on the 14th November, 1997, by Fr. Karl-Maria Brand, at the Mary, Queen of the World Church, Yaren District, Nauru.

GRAHAM B. BAGUGA of Meneng District and SUSAN KAKIAUEA also of Meneng District on the 16th November, 1997, by Rev. Labi D. Harris, at the Nauru Independent Church, Nauru.

M.B. CAIN
DEPUTY REGISTRAR,
BIRTHS, DEATHS AND MARRIAGES

LAND DETERMINATION

The Nauru Lands committee hereby determinations the ownership of certain land or shares in land as being that shown hereunder

| <u>DISTRICT</u> | <u>PORT. NO.</u> | <u>TYPE OF LAND</u> | <u>NAME OF LAND</u> | <u>REFERENCE</u> | <u>FORMER OWNER</u> | <u>SHARE</u> | <u>PRESENT OWNERS</u> | <u>SHARE</u> | |
|-----------------|------------------|---------------------|---------------------|---------------------------------|---------------------|--------------|---------------------------|------------------|-------|
| Menen | 417 | p.l. | Atebawo | Land Reg. Book 1928 page 74. | Buredauw (dec'd) | 1/2 | Etto Aingimea | 1/4 | |
| | | | | | Eibuadi (dec'd) | 1/2 | Tui Stephen | 1/56 | |
| | | | | | | | Nakori Teboua | 1/56 | |
| | | | | | | | Fredrick Teboua | 1/56 | |
| | | | | | | | Mathew Teboua | 1/56 | |
| | | | | | | | Onorio Teboua | 1/56 | |
| | | | | | | | Iba Hiram | 1/56 | |
| | | | | | | | Joanna Teboua | 1/56 | |
| | | | | | | | Elnora Watkins | 1/56 | |
| | | | | | | | Shirley Hovendene | 1/56 | |
| | | | | | | | Marlaine Akibwib | 1/56 | |
| | | | | | | | John Agege | 1/56 | |
| | | | | | | | Seymour Jonathan(LTO) | 1/56 | |
| | | | | | | | Bredauw Kabokia (LTO) | 1/112 | |
| | | | | | | | Teboua Jnr. Kabokia (LTO) | 1/112 | |
| | | | | | | | Onorio T. T/ee | (Lisa Teboua) | 1/112 |
| | | | | | | | | (Lovey Adam) | 1/112 |
| | | | | | | | | Eiriki Diema | 1/60 |
| | | | | | | | | Iyiminod Akua | 1/60 |
| | | | | | | | | Ranin Akua | 1/240 |
| | | | | | | | | Bryony Akua | 1/240 |
| | | | | | | | | Livelma Akua | 1/240 |
| | | | | | | | | Romulo Akua | 1/240 |
| | | | | | | | | Elmina Ten Tiwae | 1/240 |
| | | | | | | | | Raboe Roland | 1/240 |
| | | | | | | | | Belsina Tamakin | 1/240 |
| | | | | | | | | Nathan Aiyunge | 1/240 |
| | | | Russell Aiyunge | 1/420 | | | | | |
| | | | Roch Aiyunge | 1/420 | | | | | |
| | | | Loretta Degia | 1/420 | | | | | |
| | | | Yvonne Ika | 1/420 | | | | | |
| | | | Maureen Gabouwa | 1/420 | | | | | |
| | | | Nathan Aiyunge | 1/420 | | | | | |
| | | | Mongoria Tom (LTO) | 1/420 | | | | | |

No.95

26th November 1997

Nauru

G.N.No. 458 /1997 (cont'd)

| | | |
|--------------|-----------------------|--------|
| | Catherine Aremwa | 1/480 |
| | Narietta Harris | 1/480 |
| | Josephine Akubor | 1/480 |
| | Patricia Detenamo | 1/480 |
| | Lucy Detabouw | 1/480 |
| | Joseph Dediya | 1/480 |
| | Francis Dediya | 1/480 |
| Narietta H. | (Zarina Dediya | 1/1920 |
| Josephine A. | (Deliah Dediya | 1/1920 |
| Catherine A. | (Della Dediya | 1/1920 |
| Patricia D. | (Dante Dediya | 1/1920 |
| T/ee | | |
| | Temaungeiyeda Tannang | 1/90 |
| | Eidurubwagago Adam | 1/90 |
| | Eirubidak Iga | 1/90 |
| | Bruce Amandus (LTO) | 1/90 |
| | Nei Lopa Hedmon (LTO) | 1/90 |
| | Sally Deiranauw (LTO) | 1/90 |
| | Tania Moses | 1/720 |
| | Lucas Hedmon | 1/720 |
| | Lucia Adam | 1/720 |
| | Juliana Hedmon | 1/720 |
| | Virginia Tannang | 1/720 |
| | Pelsina Daniel | 1/720 |
| | Emerien Quadina | 1/720 |
| | Liana Apadinuwe | 1/720 |
| | Elizabeth Dekarube | 1/720 |
| | Mary Appi | 1/720 |
| | Isobel Gaiyabu | 1/720 |
| | Klem Gadaraoa | 1/720 |
| | Myrle Tom | 1/720 |
| | Roslie Gadaraoa | 1/720 |
| | Chrestina Gadaraoa | 1/720 |
| | Catherina Namoduk | 1/7200 |
| | Francine Namoduk | 1/7200 |
| | Inatio Namoduk | 1/7200 |
| | Jana Namoduk | 1/7200 |
| | Kiriwanton Namoduk | 1/7200 |
| | Krista Namoduk | 1/7200 |
| | Peter Namoduk | 1/7200 |
| | Rinna Namoduk | 1/7200 |

G.N.No. 458 /1997 (cont'd)

| | |
|-------------------------|--------|
| Saul Namoduk | 1/7200 |
| Gonzaga Namoduk (LTO) | 1/7200 |
| Rose-in Maro Deiranauw | 1/180 |
| Dagausi Deiranauw (LTO) | 1/180 |
| Dituweb Dowadi | 1/20 |
| Marie Kingrae | 1/40 |
| Mary Bill | 1/40 |
| Louise Akiri | 1/45 |
| Damien Menu | 1/255 |
| Dominic Menu | 1/255 |
| Mark Menu | 1/255 |
| Nathan Menu | 1/255 |
| Mary Anne Menu | 1/255 |
| Carren Satto | 1/255 |
| Baron Waqa | 1/255 |
| Micha Waqa | 1/255 |
| Luke Waqa | 1/255 |
| Irving Harris | 1/255 |
| Auweiyeda Star | 1/300 |
| Lantok Ephraim | 1/300 |
| Frederick Ricky Star | 1/300 |
| John Timouw Star | 1/300 |
| Lisera Agir | 1/300 |
| Eria Adam | 1/300 |
| Bonnie Temaki | 1/300 |
| Eidemoatena Temaki | 1/300 |
| Bwido Adam | 1/150 |
| Joanne E. Aubiat | 1/40 |
| Ben Ali Aubiat | 1/40 |
| Arangadoa Aubiat | 1/40 |
| Debeto Reiyetsi | 1/160 |
| Camelia Samson | 1/160 |
| Nei Retta Kingrae (LTO) | 1/160 |
| Rineidi Selo | 1/800 |
| Ingram Selo | 1/800 |
| Tonto Selo | 1/800 |
| Akogog Selo | 1/800 |
| Kerrylene Akubor | 1/800 |

NOTE: Those who disagree with the above Land Determination may appeal to the Supreme Court Registry within 21 days of the publication of this Government Gazette No

LESLIE ADAM
CHAIRMAN
LANDS COMMITTEE

LAND DETERMINATION

The Nauru Lands Committe hereby determines the ownership of certain land or share in land as being that shown hereunder:-

| <u>DISTRICT</u> | <u>PORT. NO.</u> | <u>TYPE OF LAND</u> | <u>NAME OF LAND</u> | <u>REFERENCE</u> | <u>FORMER OWNER</u> | <u>SHARE</u> | <u>PRESENT OWNERS</u> | <u>SHARE</u> |
|-----------------|------------------|---------------------|---------------------|----------------------------------|--------------------------|--------------|------------------------------|--------------|
| Menen | 419 | p.l. | Aiyuae | Land Reg.Book1928 Page 69. | Helena Star (dec'd) | 1/4 | Tamaiti W. Star | 1/32 |
| | | | | | Lily Joseph (dec'd) | 1/4 | Eli Star | 1/32 |
| | | | | | Lina Emiu (dec'd) | 1/4 | Percy Star | 1/32 |
| | | | | | Augusta Tetiboua (dec'd) | 1/4 | Gorodag Star | 1/32 |
| | | | | | | | Eidowedo Estate-Tamaiti T/ee | 1/32 |
| | | | | | | | August Grundler | 1/256 |
| | | | | | | | Barry Grundler | 1/256 |
| | | | | | | | Leonardo Grundler | 1/256 |
| | | | | | | | Trapian Grundler | 1/256 |
| | | | | | | | Samuel Grundler | 1/256 |
| | | | | | | | Cecilia Alefaio | 1/256 |
| | | | | | | | Rosa Itsimaera | 1/256 |
| | | | | | | | Lisera Chong Gum | 1/256 |
| | | | | | | | Brian Phillip | 1/224 |
| | | | | | | | Clinton Phillip | 1/224 |
| | | | | | | | John Phillip | 1/224 |
| | | | | | | | Jonathan Phillip | 1/224 |
| | | | | | | | Rona Bop | 1/224 |
| | | | | | | | Sandra Phillip | 1/224 |
| | | | | | | | Vida Dick | 1/224 |
| | | | | | | | Auweiyeda Star | 1/160 |
| | | | | | | | Dira Ephraim | 1/160 |
| | | | | | | | Tsimouw Star | 1/160 |
| | | | | | | | Lisera Agir | 1/160 |
| | | | | | | | Ricky Star | 1/160 |
| | | | | | | | Ekaura Joseph | 1/12 |
| | | | | | | | Ekauwe Joseph | 1/12 |
| | | | | | | | Eabweo Joseph (LTO) | 1/12 |
| | | Kelly Emiu | 1/4 | | | | | |
| | | Arthur Redfern | 1/24 | | | | | |
| | | Mike Redfern | 1/24 | | | | | |
| | | Bereka Tanaera | 1/24 | | | | | |

No.95

26th November 1997

Nauru

G.N.No. 459 /1997 (cont'd)

| | |
|---------------------|-------|
| Frank Roland | 1/112 |
| Irene Roland | 1/112 |
| Ken Roland | 1/112 |
| Melvin Roland | 1/112 |
| Michael Roland | 1/112 |
| Vaughn Roland | 1/112 |
| Wendy Roland | 1/112 |
| Lenice Adeang | 1/112 |
| Jillian Bam | 1/112 |
| Valda Jeremiah | 1/112 |
| Alamanda Roland | 1/112 |
| Farrah Roland | 1/112 |
| Esther Roland (LTO) | 1/112 |
| Elaine Bailey | 1/112 |

NOTE: Those who disagree with the above Land Determination may appeal to the Supreme Court Registry within 21 days of the publication of this Government Gazette No

LESLIE ADAM
CHAIRMAN

G. No. 460 / 1997.

DISTRICT OF MENENG

SCALE 1:1000

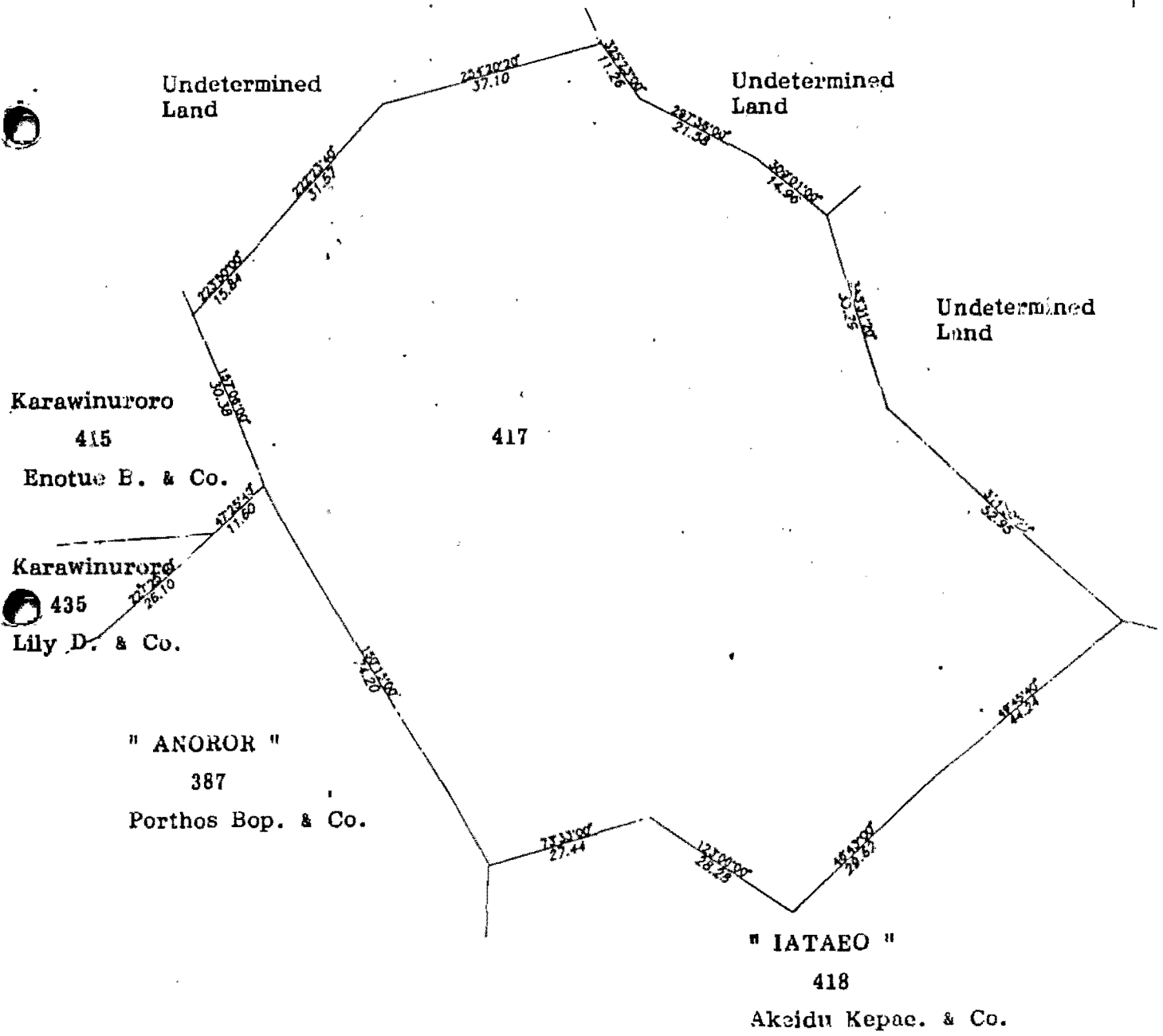

G.N.No. 461 /1997

DISTRICT OF MENENG

SCALE 1:1000



" KETAWIYI "

365

Gamanoa Joram. & Co.

" KETAWIYI "

388

Theodore Moses. & Co.

DISTRICT
21°52'00"
24.75
DISTRICT

266°37'20"
58.43

320°25'
31.72

OF
OF

320°45'
41.91
ANIBARE
MENENG

Undetermined
Land

419

" KARAWINURORO "

415

Enotue Batsiua. & Co.

Undetermined
Land

135°30'00"
16.68

135°30'00"
22.75

335°30'00"
11.26

297°30'00"
21.38

305°01'00"
17.96

275°45'00"
22.52

240°45'20"
44.66